

FOUNDATION TANK'S PLANT - GROUNDING SYSTEM DETAIL

PLAN

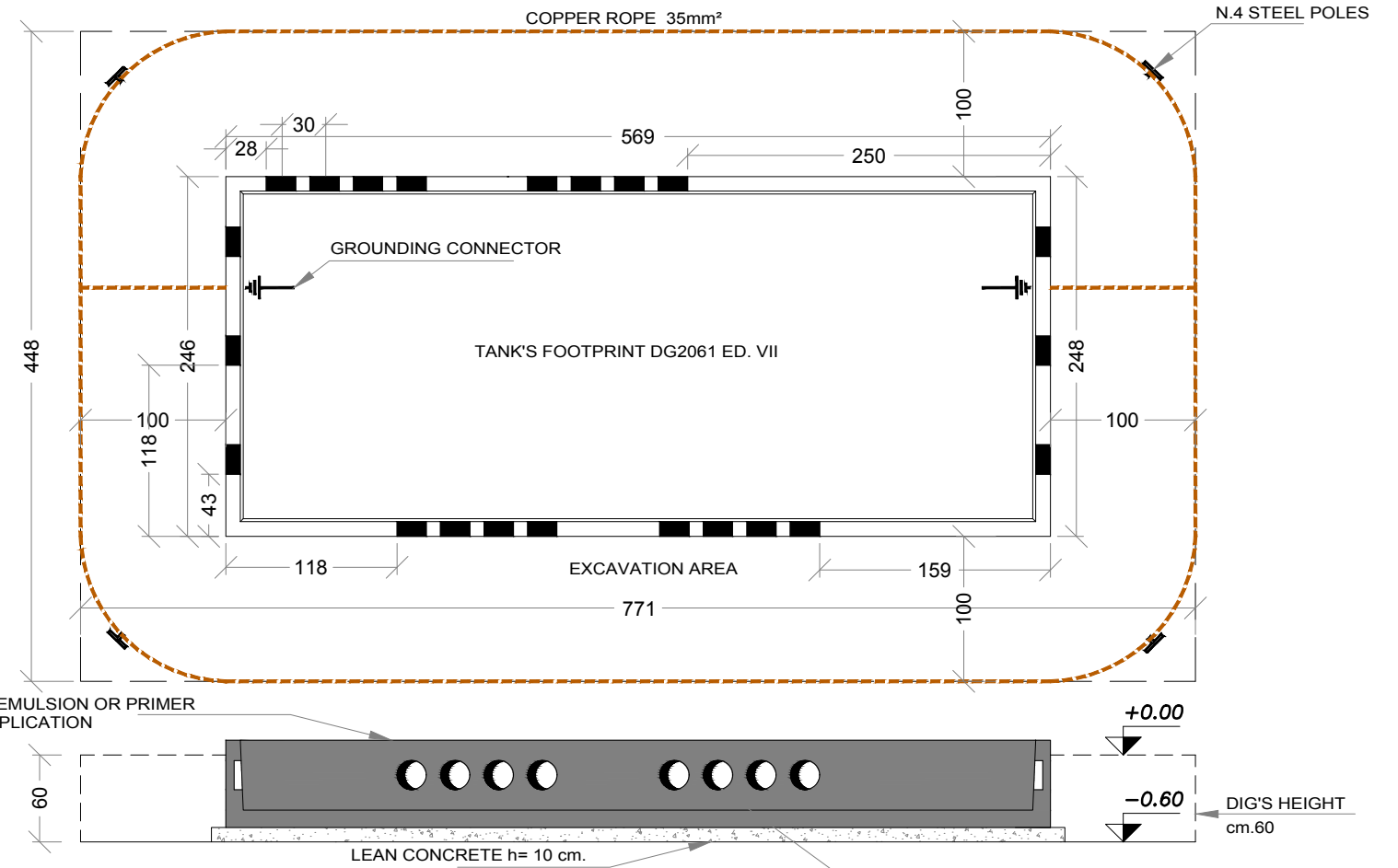

VIEW SIDE A

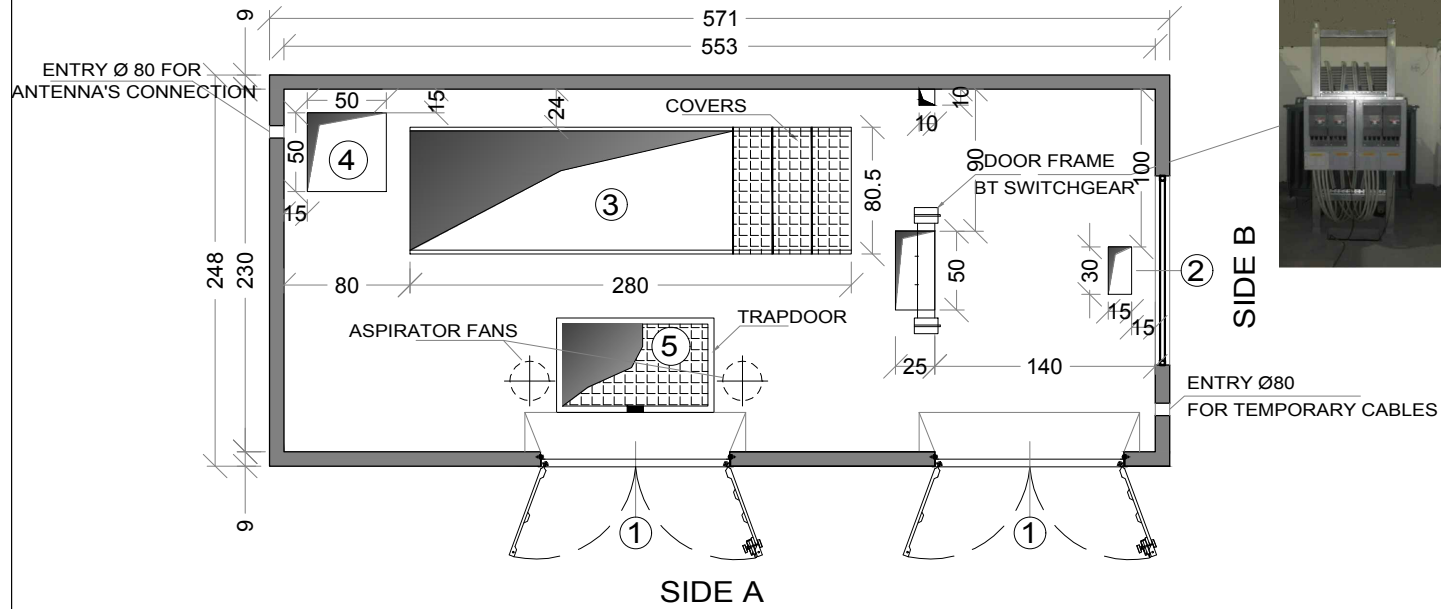
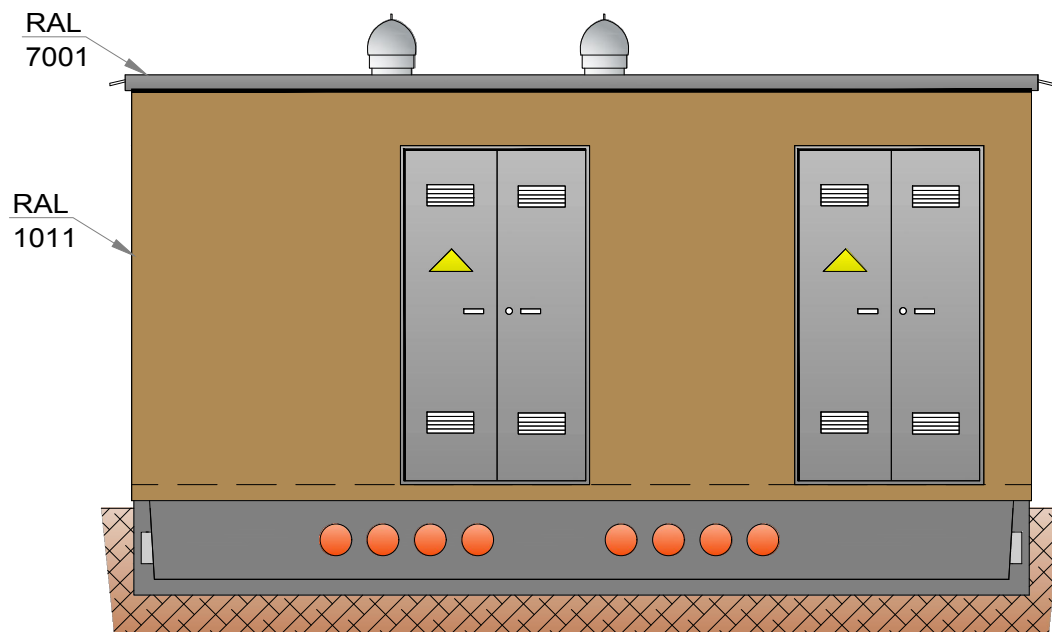

VIEW SIDE B

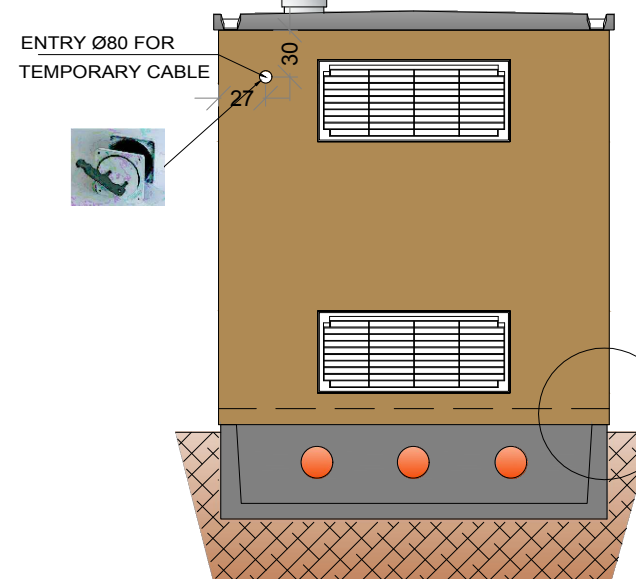

LEGEND:

- ① FIBERGLASS DOOR (CM. 120X H215)
- ② FIBERGLASS GRILL (CM. 120X H50)
- ③ HOLE CM. 280X80
- ④ HOLE CM. 50X50
- ⑤ TRAPDOOR CM. 100X60

DETAIL:  
CABIN ASSEMBLY

EQUIPMENT:

- ◆ N.3 LIGHTING LAMPS
- ◆ ENTRY FOR TEMPORARY CABLE
- ◆ ELECTRICAL CABINET FOR AUXILIARY SERVICES
- ◆ N.2 ASPIRATOR FAN
- ◆ CONNECTION FOR GROUNDING SYSTEM
- ◆ N.3 DRAPDOOR'S COVERS
- ◆ N.4 FIBERGLASS RAIN CATCHERS
- ◆ DOOR FRAME BT SWITCHGEAR

