



**BESTEFA**  
S.p.A. ROCCO IPIRICA S.R.L. UNIVERSALE

Il Tecnico:  
(Ing. P. PISANO)

# Tavola 1

di 2

## Basamento Prefabbricato in CAV per CAB 8

Dimensioni 150 x 55 x (h)20+5 cm

Scala disegno 1:10 - 1:25

**MATERIALI:**  
calcestruzzo C32/40  
acciaio B450C - S235  
Boccole S355

Ambiente: Aggressivo  
Copriferro minimo: **3,0 cm**

PIANTA Basamento in CAV per CAB8  
Scala 1:25

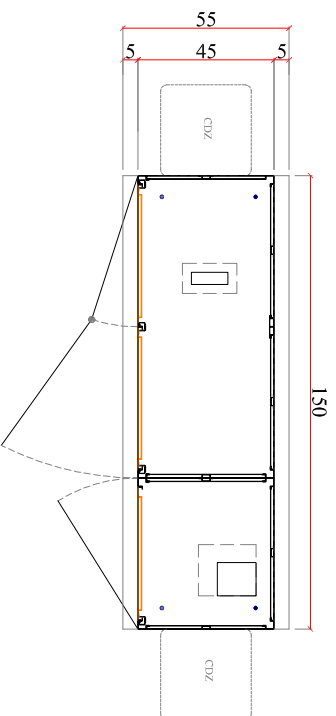

PIANTA Basamento (S=20+5 cm)  
Scala 1:25

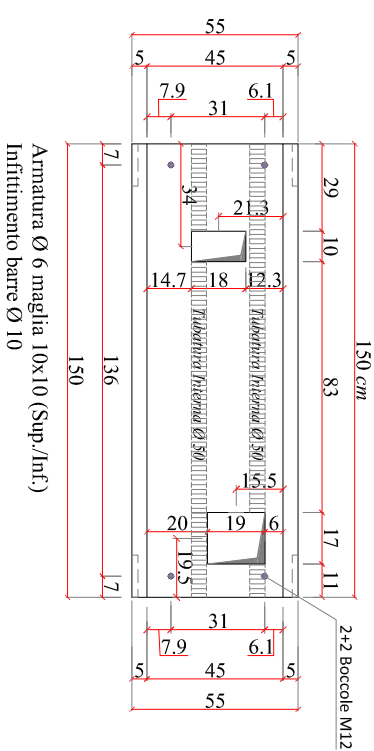

Connessione del CAB 8  
con Boccole M12 Predisposte\*\*

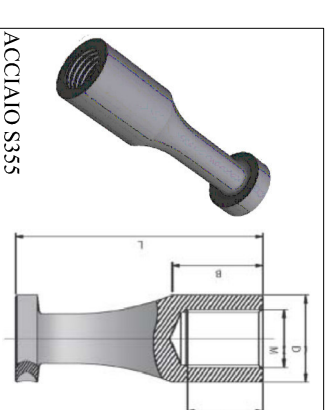

\*\* Boccola M12 con Armatura aggiuntiva

PARTICOLARE CONNESSIONE  
Scala 1:10

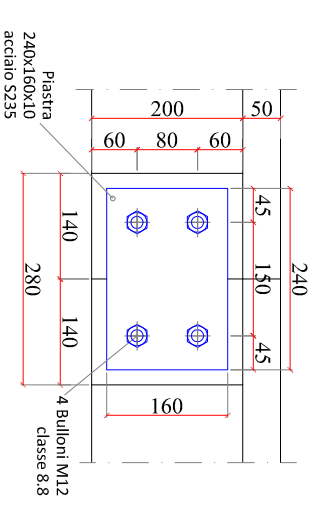
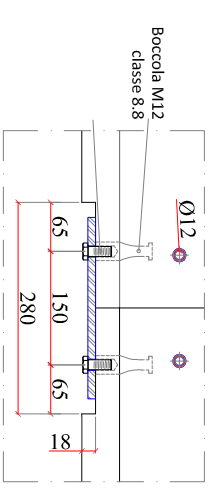

PROSPETTO Frontale  
Scala 1:25

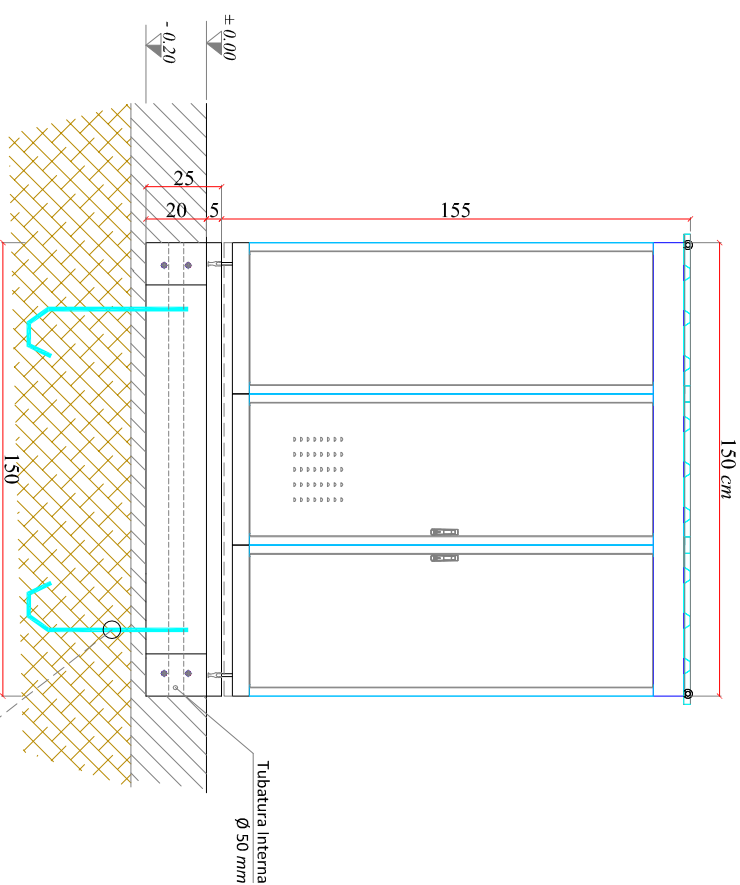

PROSPETTO Laterale  
Scala 1:25

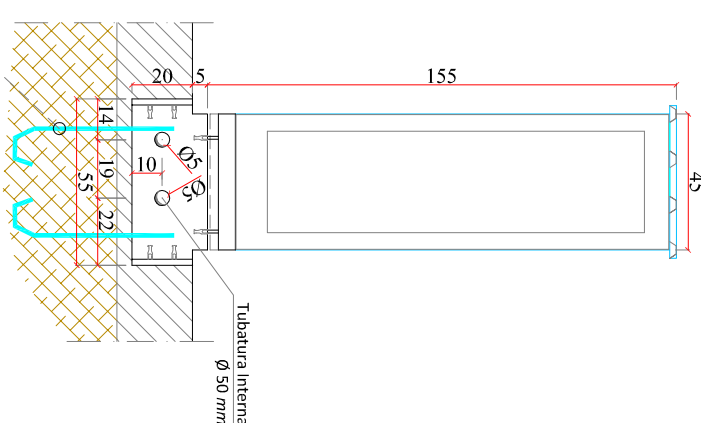

Vista 3D Basamento in CAV per CAB8

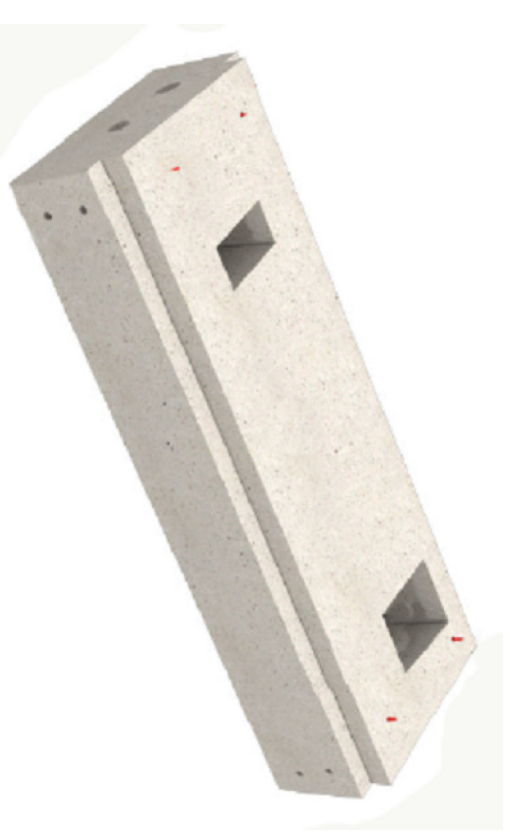

PESO Basamento CAB8: ~ **470 Kg** (mc 0.185)

4 Tirafondi se Necessari  
Valutazione per ogni sito

4 Tirafondi se Necessari  
Valutazione per ogni sito



**BESTEFA**  
S.p.A. ROCCOPIEMONTE S.R.L. UNIVERSALE

Il Tecnico:  
(Ing. P. PISANO)

# Tavola 2

di 2

## Basamento Prefabbricato in CAV per CAB 8+Espansione

Dimensioni 150 x 55 x (h)20+5 cm

Scala disegno 1:10 - 1:25

**MATERIALI:**  
calcestruzzo C32/40  
acciaio B450C - S235  
Boccole S355

PIANTA Basamento in CAV per CAB8+Espansione

Scala 1:25

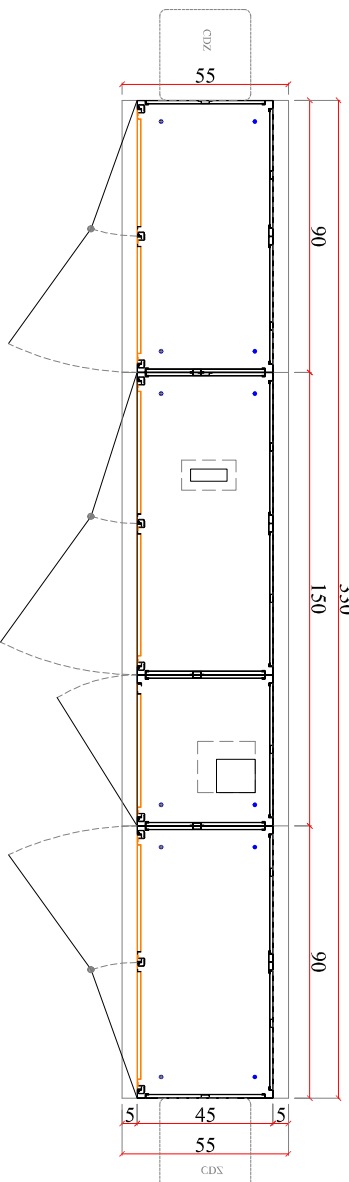

PIANTA Basamento (S=20+5 cm)

Scala 1:25

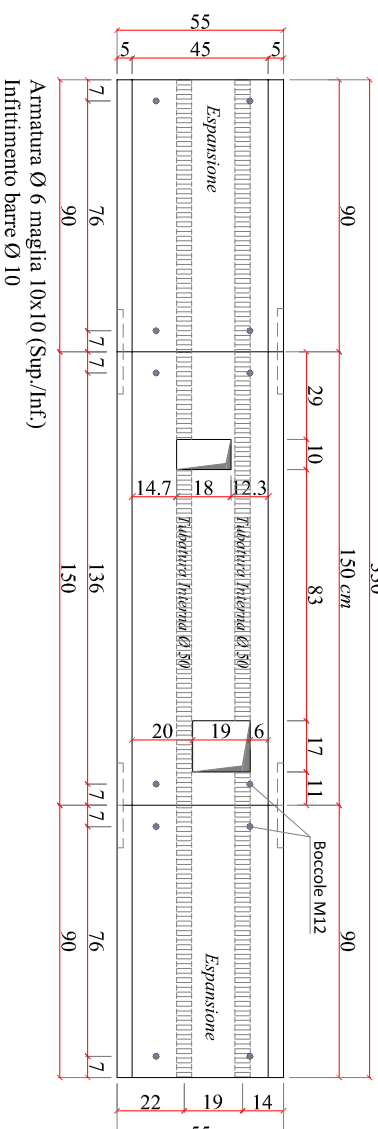

Connessione del CAB 8  
con Boccole M12 Predisposte\*\*

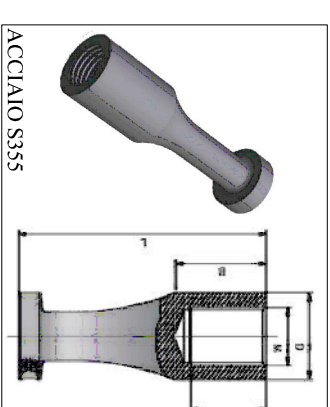

\*\* Boccola M12 con Armatura aggiuntiva

**PARTICOLARE CONNESSIONE**  
Scala 1:10

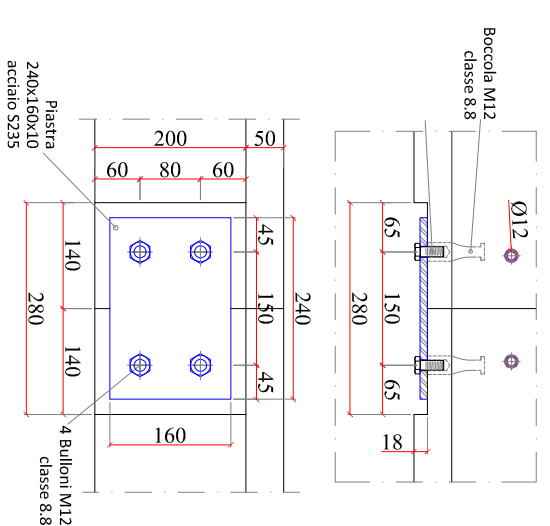

Pastrina 240x160x10 acciaio S235  
4 Bulloni M12 classe 8.8

ACCIAIO S355

PROSPETTO Laterale

Scala 1:25

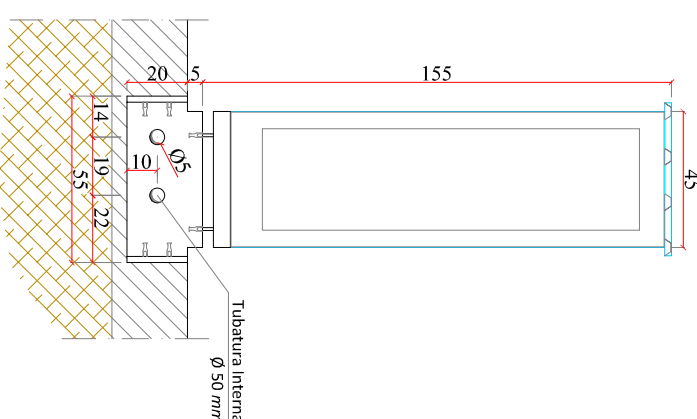

PROSPETTO Frontale

Scala 1:25

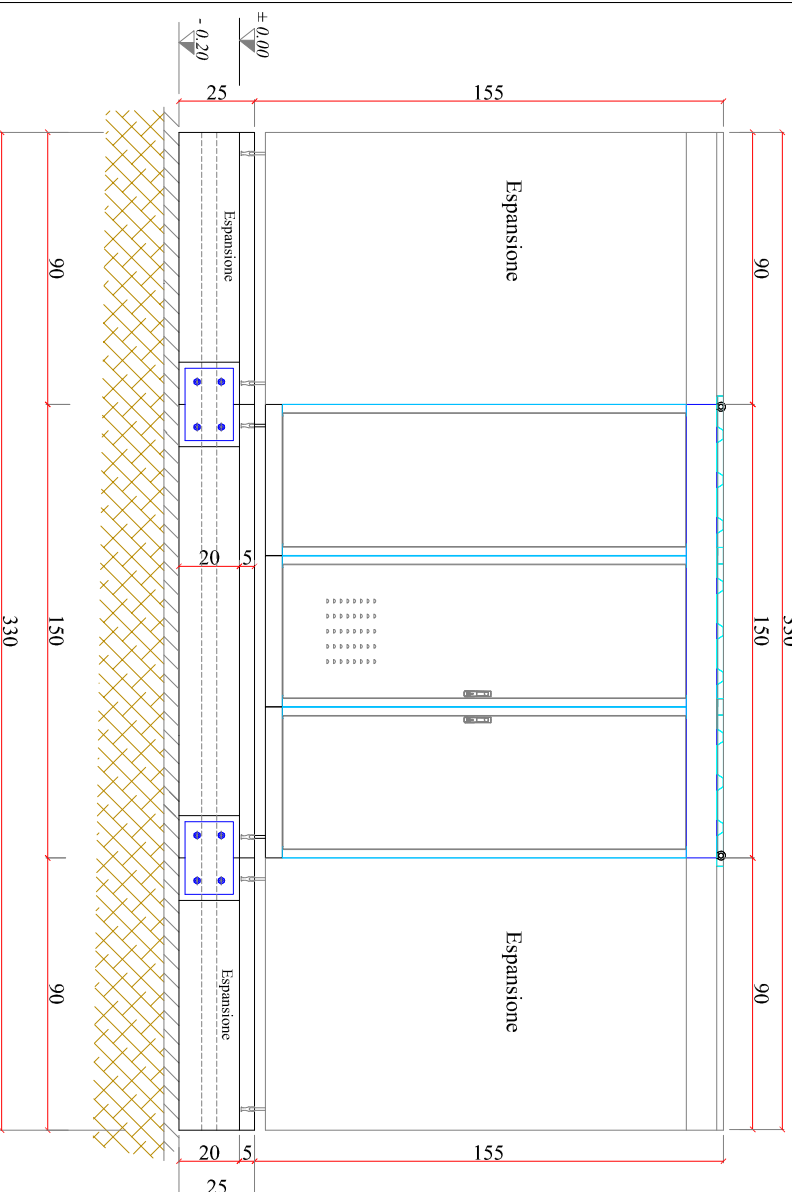

Vista 3D Basamento in CAV per CAB8 + Espansione Dx/Sx

